

# Electrical Requirements For Elevator Machinery Space

## BY GENERAL CONTRACTOR / OWNER

Each home elevator requires five (5) items from your Electrician and Telecommunications Contractor(s):

### NOTES

1. Main Power - 10/3 with Ground (min. 6") pigtail connected to house 30 Amp dedicated circuit. 240VAC for LLH REQUIRES neutral.
2. Cab Light Power - 12/2 with Ground (min. 6") Pigtail connected to house 20 Amp dedicated circuit.
3. One (1) GFI Outlet separate from #2 elevator (120VAC) circuit. This should be on same circuit as #4.
4. One (1) Light Fixture (with protective cover over bulb) with wall switch on lock side of entry door.
5. One (1) Live Land Based Phone Line with pigtail (10'-0" Min.) per code.

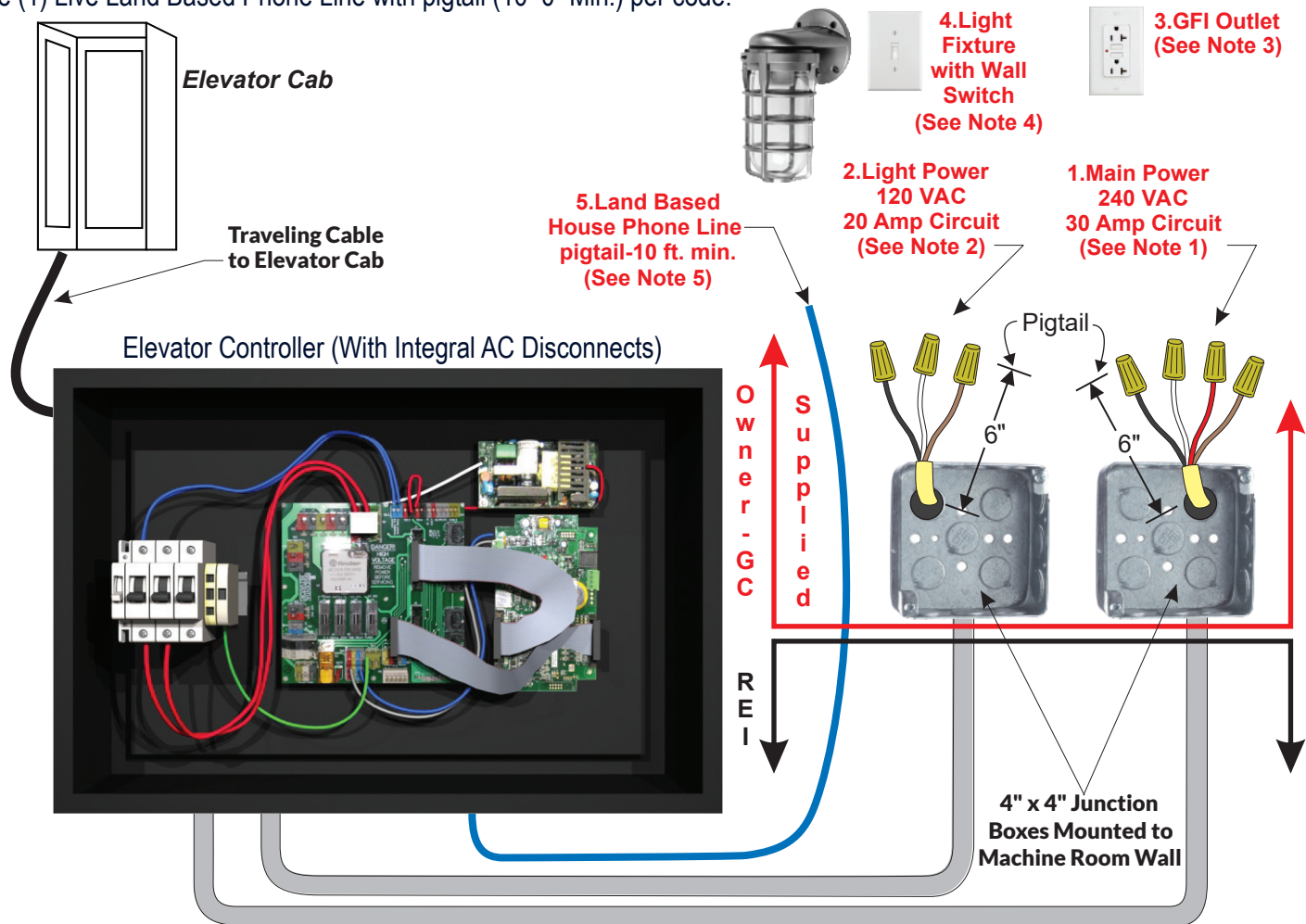

PLEASE BE ADVISED THAT POWER ON THE 240VAC LINE MUST BE A 10-3 WIRE WITH A GROUND AND DEDICATED NEUTRAL TO THE UNIT.

Explanation-The 240VAC feed should have a black, red, white, and ground wire to the machine room. All electrical contractors will have full knowledge of this requirement. Simply insure they are aware of this requirement. Black and Red are powered with 120VAC each, totaling 240VAC. White is neutral. Ground to ground standard. Also, standard telephone line or Ethernet cable should be pulled to the machine room with approximately ten extra feet inside machine room. If further explanation or clarification is needed, please contact your local sales representative.

# Electrical Layout For Elevator Machinery Space

## TRACTION (LLT) APPLICATION

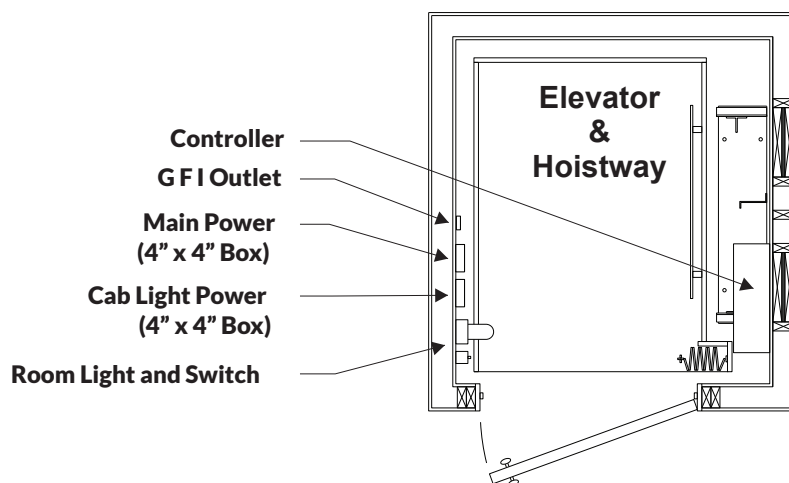

## HYDRAULIC (LLH) APPLICATION

